



Ming Ao Technology

for your independence

# Fixture Instructions

Shandong Mingao Automobile Technology Co., Ltd

# Catalog

Must read for customers.....	3
1、 Product description.....	4
2、 Product structure and identification.....	5
3、 Product installation method.....	10

# Must read for customers

This manual can guide you on how to install and debug the product. If you have any questions during the installation process, please contact us and we will provide you with timely and satisfactory solutions.

The description of this manual is for reference only. If there is any discrepancy with the product status, please refer to the actual product. If you have any questions about the manual or need a copy, please contact our company.

Thank you again for choosing us and wish you a happy life!

Version number of this manual: V2.0.

## **Shandong Mingao Automobile Technology Co., Ltd.**

Company Phone: 400-833-6602

After-sales phone: 18364060737

Website: [www.mingao.top](http://www.mingao.top)

E-mail: [Jonfeng@mingao.top](mailto:Jonfeng@mingao.top)

Address: Zhuoda Industrial Park, Changjiang East Road, Development Zone, Heze City, Shandong Province

# 1、Product description

Disabled people need to carry wheelchairs on vehicles when traveling. To avoid the wheelchair from shifting or even colliding or overturning when starting, braking, emergency braking, turning or passing through rough roads, a wheelchair fixing device that can improve the above defects is designed.

1. A new type of wheelchair fixing device, including a fixing component and a retracting mechanism. The fixing component can be detachably connected to the disc base of the ground rail. The fixing component includes a disc-type fixture, which is installed in the card slot of the disc base. The disc-type fixture is connected to the main connecting frame through screws and positioning pins, and the main connecting frame is connected to the retracting mechanism and the seat belt fixing plate through screws respectively. The retracting mechanism includes a belt box, which contains a connecting belt, and the inner end of the connecting belt is connected to a locking component; the locking component includes a self-recovery unit for controlling the locking of the connecting belt, a stretching pin for unlocking and locking the self-recovery unit, and an adjustment knob for fine-tuning the connecting belt; the outer end of the connecting belt is connected to a hook, and the other end of the hook is connected to the wheelchair.

2. When using the new wheelchair fixing device, push the stretch pin to the unlocking position, pull the end of the hook set on the connecting belt outward to an appropriate length, hook the hook to the corresponding part of the wheelchair, turn the adjustment knob to tighten the connecting belt to complete the connection between the adjustment fixing assembly and the wheelchair. After use, first turn it in the opposite direction to push the stretch pin to the unlocking position, and then remove the hook from the wheelchair. Under the action of the automatic recovery unit, the connecting belt is automatically retracted into the belt box. The automatic recovery unit is a prior art, such as that used for automatic retraction of seat belts.

## 2、Product structure and identification

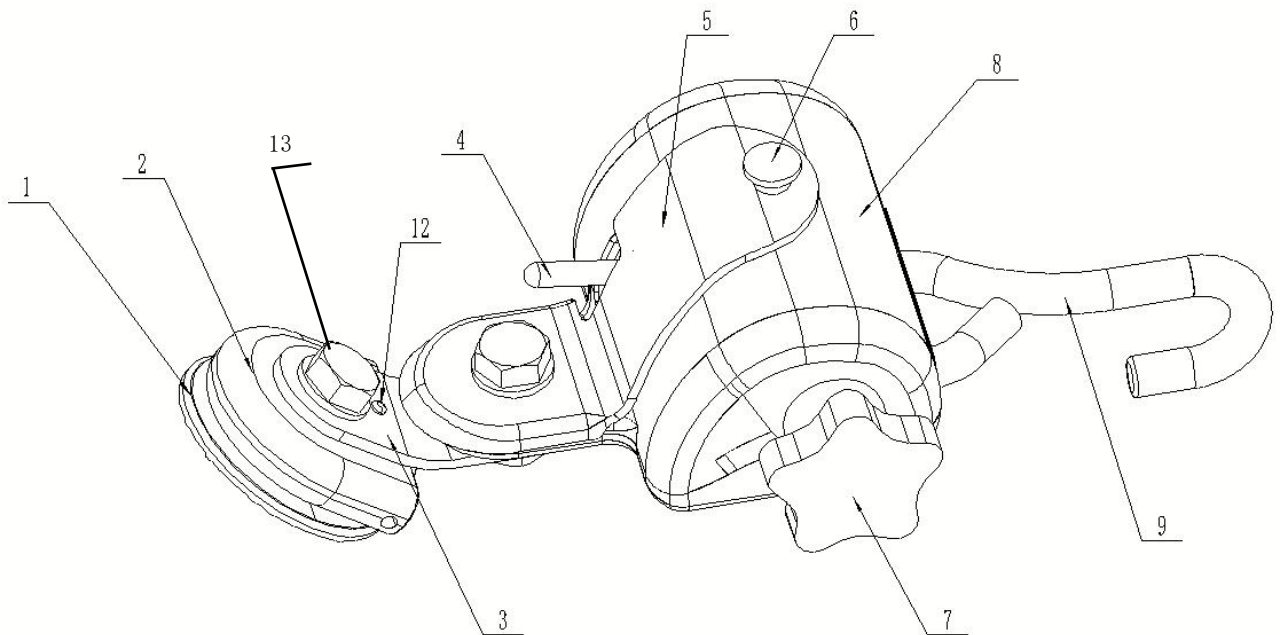
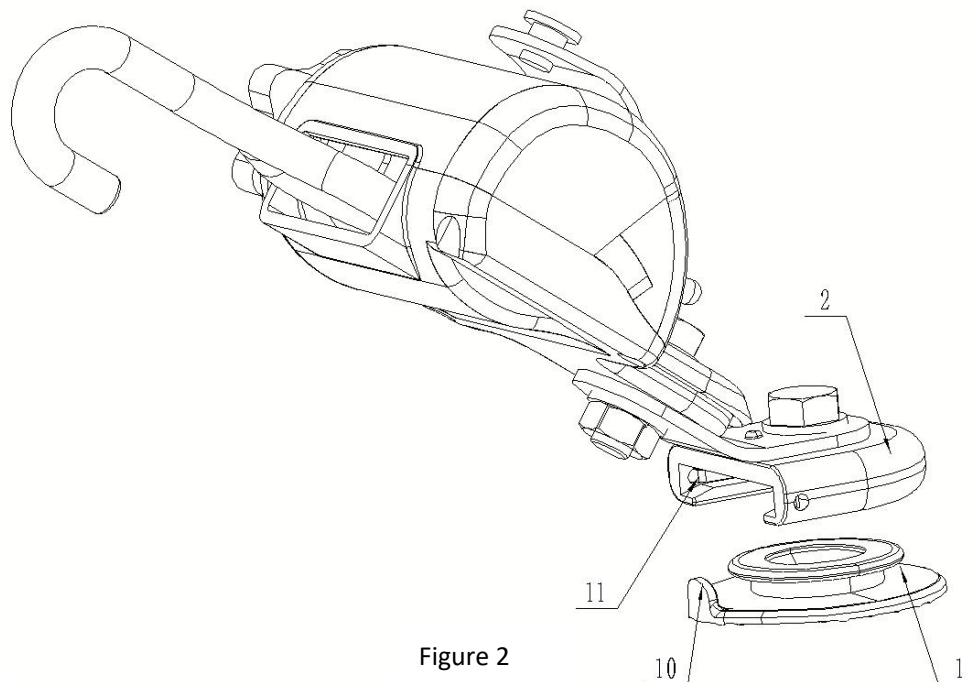

Figure 1

Schematic diagram of the wheelchair fixing device

Serial number	Name
1	Disc holder
2	Disc base
3	Main connecting frame
4	Stretch pin
5	Safety belt fixing plate
6	Safety belt latch
7	Adjustment
8	Belt box
9	Hook
12	Locate pin
13	M10 hexagon screw



Exploded view of a wheelchair securing device

Serial number	Name
1	Disc holder
2	Disc base
10	Limiting point
11	Limiting spring

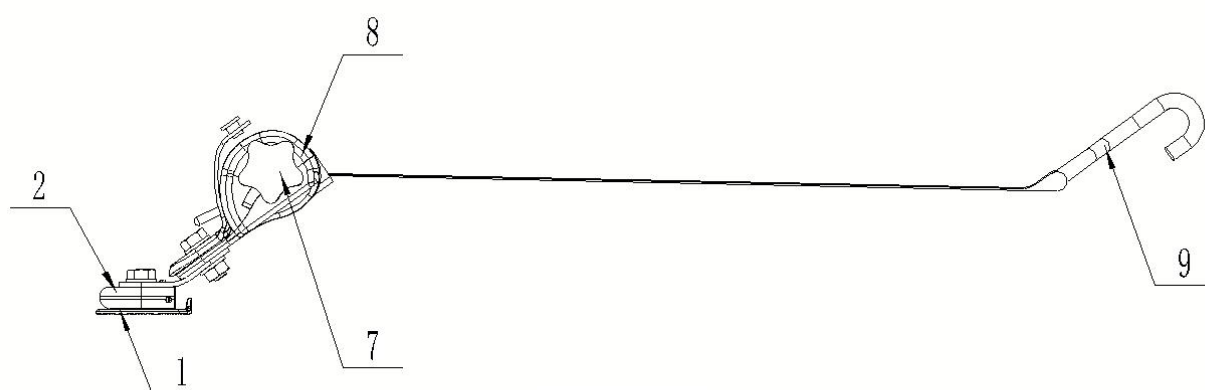
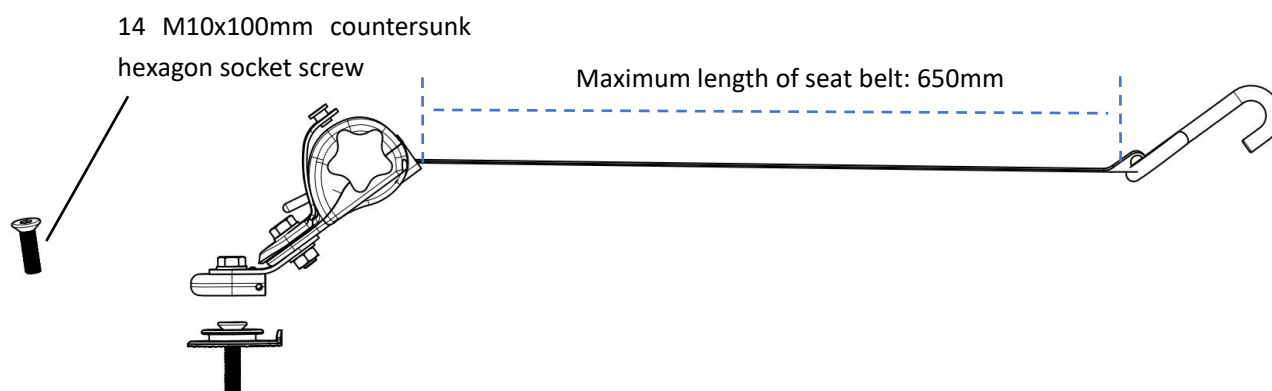

Figure 5

Side view of the wheelchair fixing device in working

Serial number	Name
1	Disc holder
2	Disc base
7	Swivel
8	Rope box
9	Hook

### 3、Product installation method



M10x100mm countersunk hexagon socket screws are fixed to the vehicle chassis, the disc holder is fixed to the vehicle body, and the disc base is clamped on the disc holder (as shown in the figure below)



It comes with a 2-point safety belt, which does not require additional holes to be punched and fixed; the safety belt is clipped on the safety belt pin, and the length of the safety belt can be adjusted by yourself. (As shown in the left picture)



## Schematic diagram of the working state structure of the wheelchair fixing device

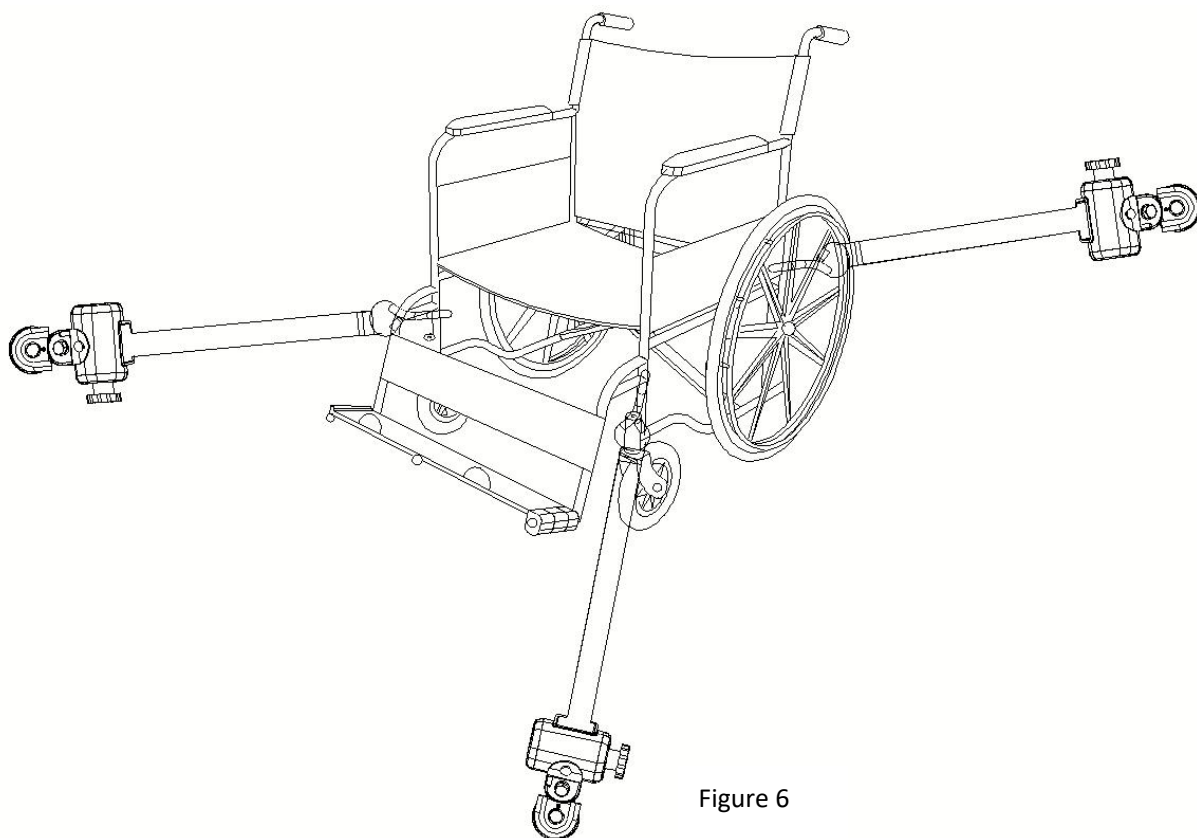

Figure 6

Install the disc holder position according to the wheelchair size. The disc holder is installed on the outside of the wheelchair.